

4K+ Large Format Wide Angle Lens



Description

The DSL592 is a large-format, all-glass fisheye lens designed to give a full circular image on large format 1" sensors with resolution up to 20MP with 2 μ m pixel size.

Key Features

- 150° Field of View
- F- θ for consistent angular resolution
- Very high resolution
- All-glass construction for superior environmental stability.

Optical Specifications

Sunex PN DSL592	
Description	All-Glass Wide Angle Lens
Imager Format	1" Class
Nominal Imager Resolution	Up to 20 MP
Focal Length	5.9mm
Relative Aperture (F/#)	F/2.9
Image Circle	16.0mm
Field of View	150° at 15.3mm image circle
Total Track Length	44mm
Distortion	0% F- θ
Chief Ray Angle	11° at 15.3mm image circle
IR cut-off filter	Optional IR Cutoff filter at 650nm

Applications

- Security/Surveillance
- Broadcast Cameras
- Video Conferencing
- Immersive Imaging

DSL592A-BCG-F2.9 Mechanical Dimensions [mm]:

The DSL592A-BCG-F2.9 is designed to be used with a custom M20 threaded mount or the Sunex CMT2035-C C-Mount thread adapter

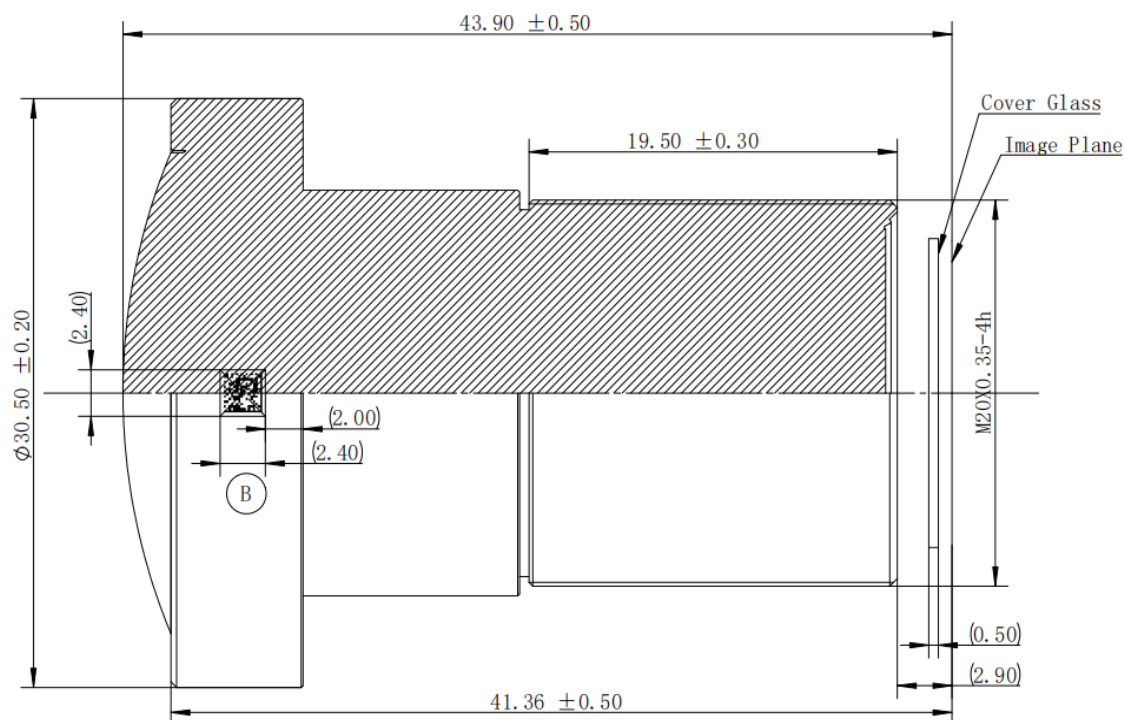

Notes:

1. EFL = 5.9 ± 5%;
2. F/# = 2.9 ± 0.15;
3. Barrel material: Black anodized AL6061;
Cap material: Black anodized AL6061;

DSL592A-NIR-F2.9 Mechanical Dimensions [mm]:

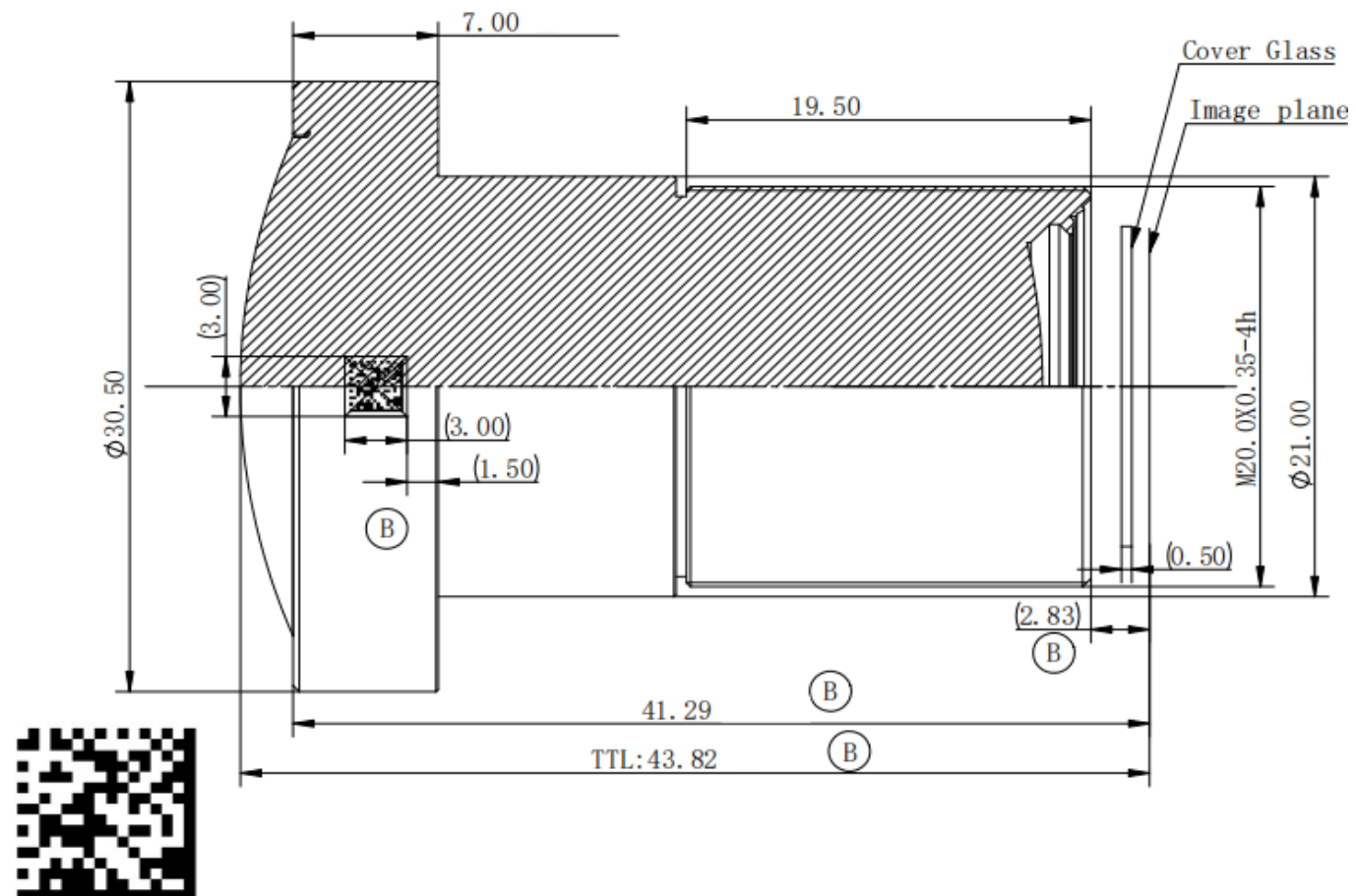

SUBJECT TO CHANGE WITHOUT NOTICE

Sunex, Inc.
Telephone: +1 760 597 2966
www.sunex.com