

FOVEA Distortion Wide-Angle Lens



Description

The DSL457 is a wide-angle FOVEA Distortion lens designed for 1/1.7" imager formats. The athermalized design combined with a large depth of focus yields optimal performance with temperature. The DSL457 has superior HDR capability and low F/#, making it ideal for various light conditions.

Key Features

- Thermally Stable
- Fovea Distortion profile
- All-Glass
- Low F/#

Optical Specifications

Sunex PN DSL457	
Description	All-Glass FOVEA Wide-Angle Lens
Imager Format	1/1.7"
Nominal Imager Resolution	8.3MP
Focal Length	5.1mm
Relative Aperture (F/#)	1.6
Image Circle	9mm
Field of View	120°
Total Track Length	26.2mm
Distortion	-56% F-tan theta
Chief Ray Angle	18.0°
IR cut-off filter	700nm IR cut

Applications

- Automotive
- Security/Surveillance

DSL457J-700-F1.6 Mechanical Dimensions [mm]:

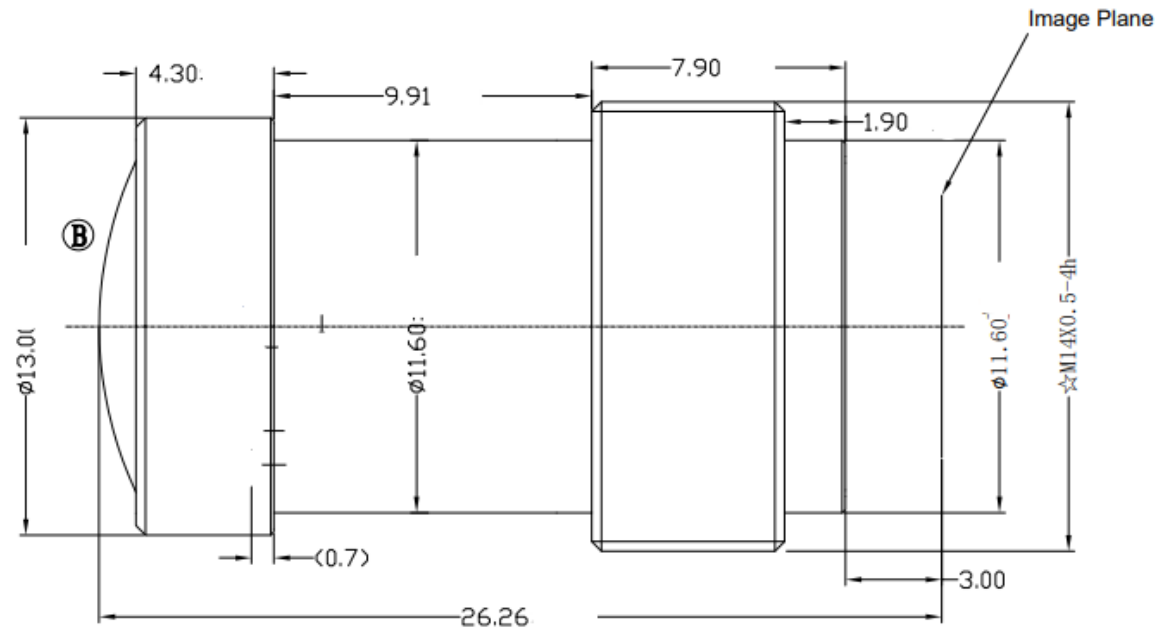

Notes:

1. EFL=5.1 %;
2. F#=1.8: %;
3. Barrel Material: AL6061
Cap Material: Anodized AL6061;
4. IR cut point: T=50%@700±10nm;
UV cut point: T=50%@410±10nm;