

Wide-Angle HD/HDR Lens



Description

The DSL958 lens is an all-glass lens designed for HD/HDR imagers with up to 1/3" format. Special optical design and process techniques are applied to achieve high resolution and low F/# with minimized stray light and ghosting.

Key Features

- F/1.7 for enhanced low light sensitivity
- All glass to optimize thermal stability
- Low stray light for HDR sensors

Optical Specifications

Sunex PN DSL958	
Description	Wide Angle HD/HDR Lens
Imager Format	Up to 1/3"
Nominal Imager Resolution	1.3MP
Focal Length	4.6mm
Relative Aperture (F/#)	F/1.7 (standard), F/4.0
Image Circle	6.0mm
Field of View	76° at 6.0mm image circle
Total Track Length	21.1mm
Distortion	17% rectilinear
Chief Ray Angle	15° at 6.0mm image circle, linear
IR cut-off filter	Optional 700nm IR cutoff filter

Applications

- Automotive Forward Machine Vision (Sensing)
- Automotive Mirror Replacement (CMS/eMirror)
- Security Cameras
- Computer Vision

DSL958E-700-F1.7 and DSL958E-NIR-F1.7 Mechanical Dimensions [mm]:

Note: DSL958E is intended for use with Sunex CMT801 mount

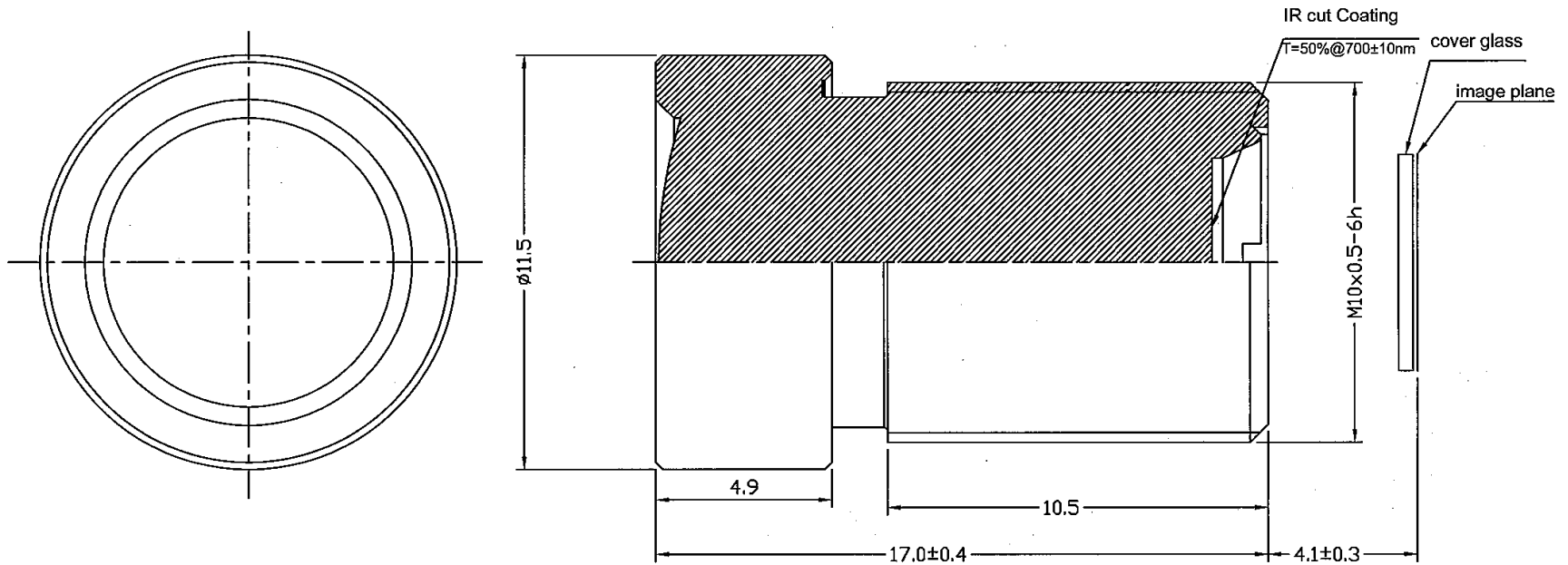

DSL958G-700-F1.7, DSL958G-NIR-F1.7, and DSL958G-700-F4.0 Mechanical Dimensions [mm]:

Note: DSL958G is intended for use with Sunex CMT821, CMT107 and CMT804 mounts

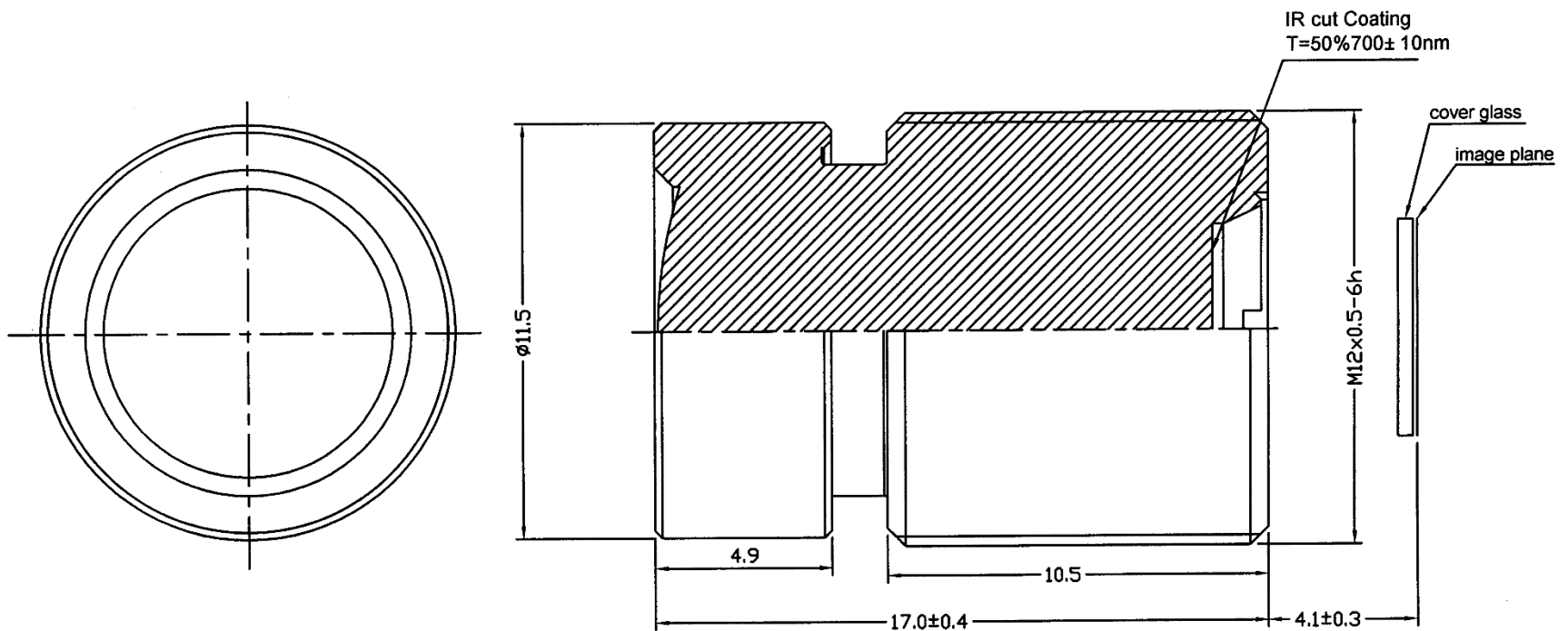

DSL958R-650-F1.7 Mechanical Dimensions [mm]:

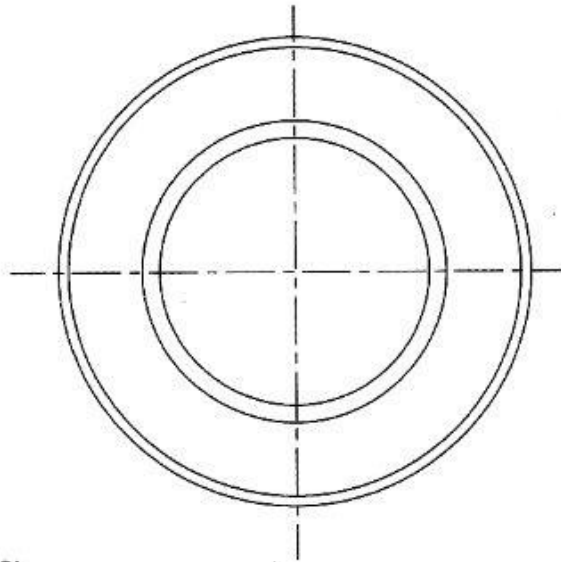

Notes:

- 1. EFL=4.6
- 2. F#=1.7
- 3. Barrel Material: AL6061
- 4. IR cut Coating:
T=50%@650±10nm

