

High Resolution Miniature SuperFisheye™ Lens



Description

The DSL217 lens is a miniature, high-resolution SuperFisheye™ lens designed with a horizontal field of view greater than 180 degrees on 1/4" to 1/2.8" format imagers with up to 5MP resolution. These features, along with a low F/#, make the DSL217 ideal for low light applications in the security market.

Key Features

- Maximum field of view (FOV): 185°
- F/1.8 aperture for low-light performance
- Hybrid glass-plastic design
- Suitable for megapixel resolution sensors

Optical Specifications

Sunex PN DSL217	
Description	Miniature SuperFisheye™
Imager Format	Up to 1/2.8"
Nominal Imager Resolution	3MP-5MP
Focal Length	1.3mm
Relative Aperture (F/#)	F/1.8
Image Circle	3.8mm
Field of View	127° at 2.7 mm image circle 185° at 3.8 mm image circle
Total Track Length	18mm
Distortion	-9% from F-θ
Chief Ray Angle	18.2° at 3.8mm image circle, linear
IR cut-off filter	Optional 670nm cutoff filter

Applications

- Security/Surveillance
- 360° camera / Immersive Media / VR
- IoT cameras

Excellence in Digital Imaging Optics

Image circle format using a 4:3 aspect ratio imager:

Image Circle vs. Sensor Format

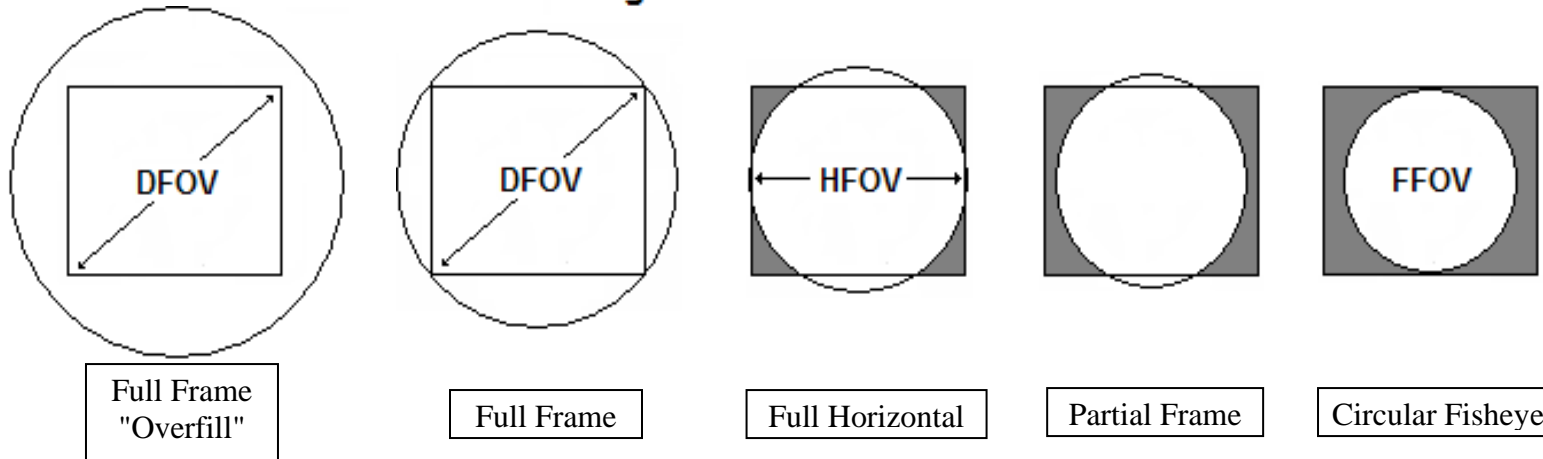

DSL217 on: 1/5" and smaller

~1/5"

~1/3.6"

~1/3.2"

1/2.8" or larger

Excellence in Digital Imaging Optics

DSL217C-650-F1.8, DSL217C-670-F1.8, DSL217C-NIR-F1.8 and Mechanical Dimensions [mm]:

Note: DSL217C is intended for use with Sunex CMT821

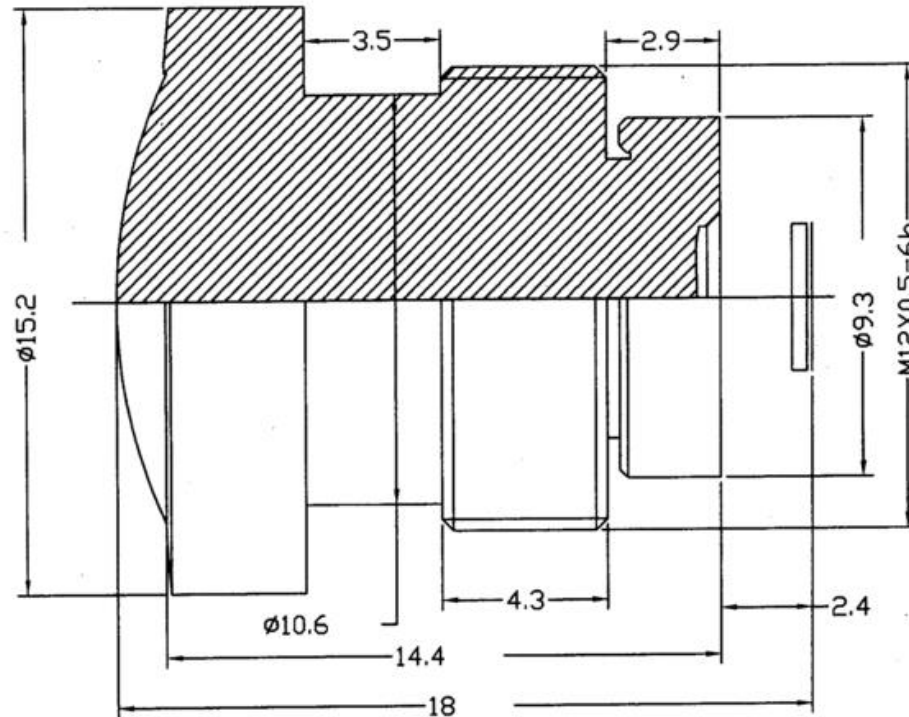

SUBJECT TO CHANGE WITHOUT NOTICE

Sunex, Inc.
Telephone: +1 760 597 2966
www.sunex.com

DSL217D-NIR-F1.8 and Mechanical Dimensions [mm]:

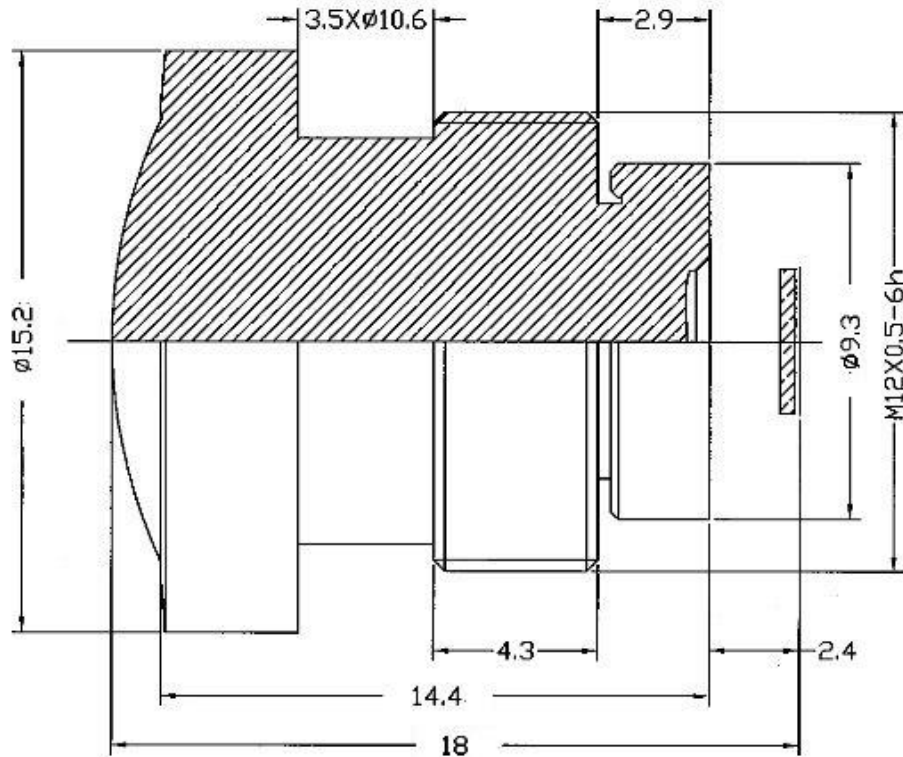

Note:

- 1.F/#:1.8:
- 2.Effective focal length:1.3mm
- 3.Barrel Material:Black anodized AL.